

Cinemas 2 & 3 Beech Street – Ground Floor Level

Barbican Centre
Silk Street
London EC2Y 8DS
+44 (0) 20 7382 7043
businesses@barbican.org.uk
barbican.org.uk

Capacity of each cinema

Total 153
with 3 wheelchair spaces
or 147 with 6 wheelchair spaces

Cinema 2 stage dimensions

area 10.5m² (113 sq. ft.)
width 7.0m (22.1")
depth 1.5m (4.11")
max height 4.05m (12'11")

Cinema 3 stage dimensions

area 10.3m² (111 sq. ft.)
width 6.88m (21'7")
depth 1.5m (4'11")
max height 4.05m (12'11")

Facilities

- free Wi-Fi
- perlux cinema screen (max 18.3" x 9.9" with variable side masking)
- full facilities for video and data projection
- dedicated technician
- fixed stage of 10.5m²
- integrated sound system (16 channel desk with tie lines from stage and auditorium to control room)
- stage lighting with colour changing auditorium lights
- induction loop
- air conditioning
- private foyer area (in Exhibition Hall 1)
- step free access at ground floor level
- wheelchair accessible for delegates

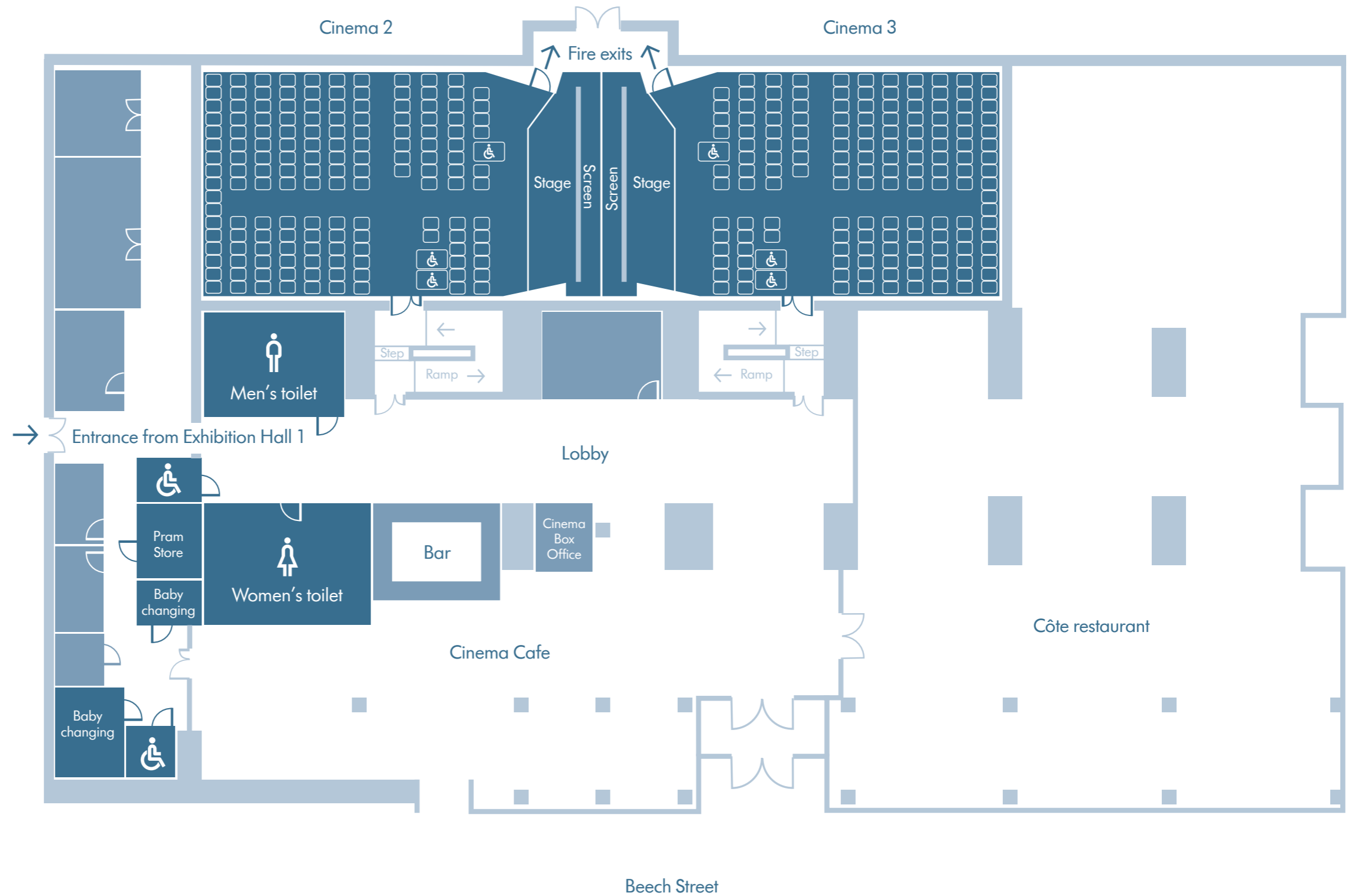

Exhibition Hall 1 (Lower) Entrance via Golden Lane

Barbican Centre
Silk Street
London EC2Y 8DS
+44 (0) 20 7382 7043
businesses@barbican.org.uk
barbican.org.uk

Capacity

Reception 250 max
Exhibition 250 max
Conference catering 250 max
(subject to exhibition layout)

Dimensions

area 204m² (113 sq. ft.)
width 9.15m (30.0") max
general width 4.85m (15.11")
length 32.15m (105.4")
height 2.10m (6.11") max
height 2.07m (6.09") min

Facilities

- free Wi-Fi
- dedicated entrance for guest arrival on Golden Lane
- registration desk
- staffed cloakroom facilities
- poster frames available for client branding
- white panelled walls with niches suitable for flexible event layout
- step free access at ground floor level
- wheelchair accessible
- front of house and cloakroom staff included in the venue hire

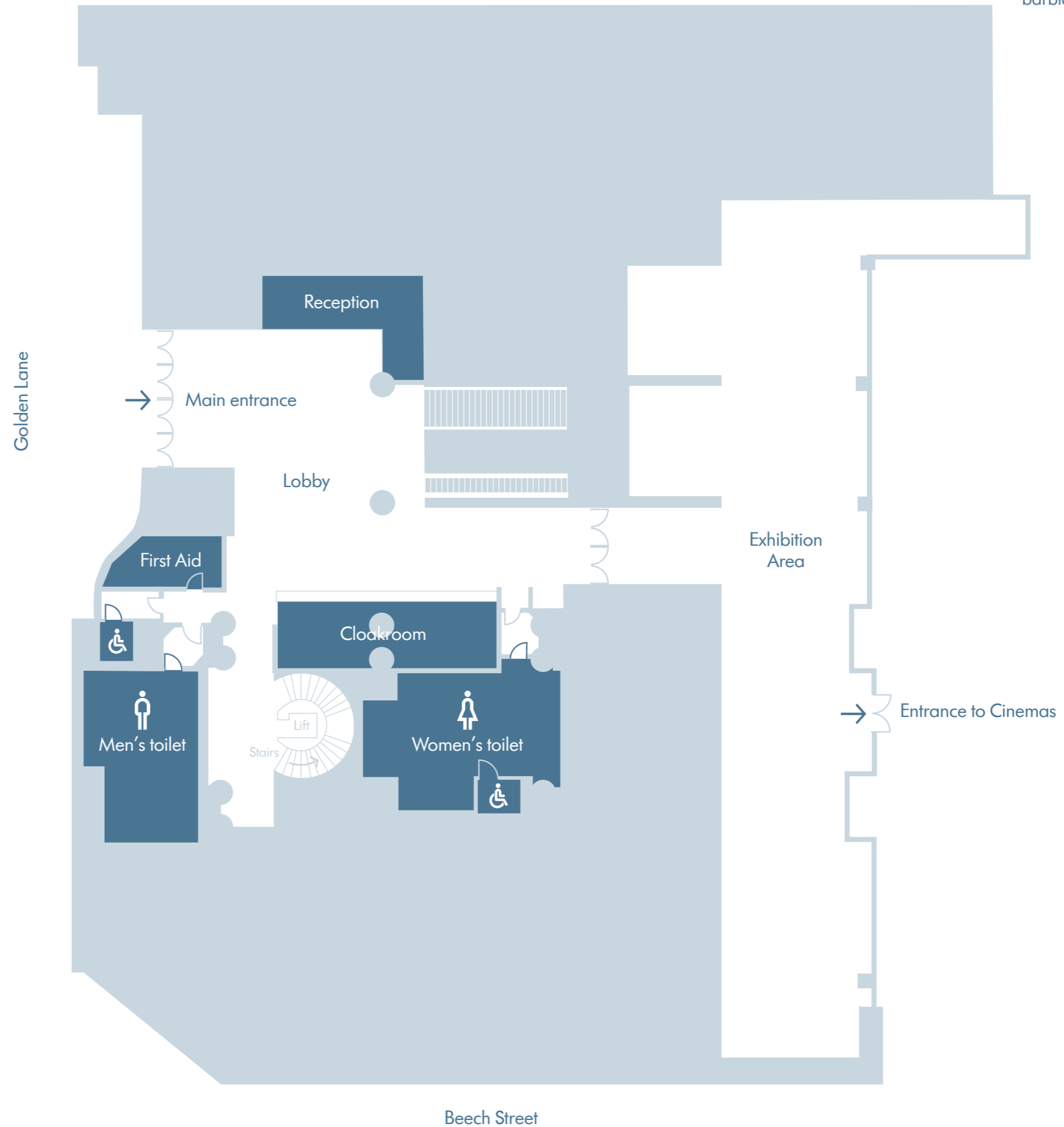

Exhibition Hall 1 and Cinemas 2 & 3

Barbican Centre
Silk Street
London EC2Y 8DS
+44 (0) 20 7382 7043
businesses@barbican.org.uk
barbican.org.uk

